

The stackable washer and dryer boast energy-saving features and sleek designs. For an artistic touch, the homeowner had a creative pattern drilled into the panel at the top of the laundry center.



This laundry proves that a room can be pretty, functional, and fresh, as well as environmentally thoughtful.

clean and serene



"I set out to create a multifunctional space that is pleasing to the eye and to the environment."

The homeowner chose cabinetry that received the Environmental Stewardship Program seal of approval from the Kitchen Cabinet Manufacturers Association (KCMA), indicating a commitment to sustainability.

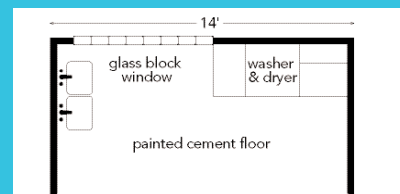

What They Did

THE CHALLENGE: This basement laundry was drab and cluttered, serving as a storage room for everything from tableware to bed linens. The homeowner needed an efficient laundry space and a small organized area for garden planning.

THE SOLUTION: The homeowner added cabinetry and shelves, and she selected a stackable washer and dryer to free up room for a workspace. A small desk area gives her a mini-office. She uses a table mounted on casters for sorting and folding clothes. To brighten the dark basement, the improved lighting plan includes natural, overhead, and task lighting.



This homeowner doesn't mind doing laundry chores. But she didn't look forward to the dark, disorganized basement that houses her washer and dryer. When she decided to remodel this space, the avid gardener and nature lover was committed to making her laundry eco-friendly as well as stylish and functional. She also wanted to carve out a space for a desk and organization area, where she plans to work on garden designs.

Now, a mix of energy-efficient lighting, which includes recessed, flush-mounted, and under-cabinet fixtures, brightens the room. The homeowner was willing to splurge on the washer and dryer, cabinetry, and ceiling planks—products that are eco-friendly and sustainable. Reused items, such as two metal tubs turned into sinks, underscore the green theme. Gardening supplies are housed on a custom-built shelf above the sinks.

The revamped laundry—complete with a fresh, outdoorsy palette of pale greens, blues, and whites—suits the homeowner's taste and needs, as well as her environment-conscious outlook. "I truly feel good about this room," she says. "It fits me inside and out."

Savvy Storage

» The smart desk-and-organization nook transforms this space from a simple laundry to a multiuse room. The Corian countertop provides a durable, hardworking surface, and under-mounted cabinet lights add sufficient task lighting. Above the desk, open cubbies allow items to be easily accessible. On the adjacent wall, peg-board keeps tools organized.

The homeowner splurged on the white wood-look laminate ceiling planks. A special finish on the planks blocks mold and mildew, making them ideal for humid areas such as this basement.



"I love to garden, so we carved out a space for my planning and research."



You can find how-to instructions and a list of tools and materials for building the shelf above the sinks at Lowe'sCreativeIdeas.com/Sep071.



The homeowner made these sinks using metal tubs found at a local salvage store. A contractor cut holes in the bottom of each tub and then connected the drain lines. A few coats of Rust-Oleum Cold Galvanizing Compound makes the old tubs look new.

Green Idea

The room was painted with Olympic Premium paint, which is Green Seal Certified, contains zero VOCs, and dries with no lingering odor.

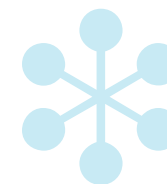

Lowe's List

- Skill level: **Advanced**
- Rough cost estimate . . . **\$10,100***
- Cabinetry and countertops \$5,175
- Appliances \$2,475
- Plumbing \$320
- Lighting \$410
- Paint \$125
- Home organization \$45
- Millwork \$1,480
- Shelf project \$70
- Rough time estimate: **2 weeks****

CABINETRY AND COUNTERTOPS

- cabinetry (Shenandoah, McKinley, Maple, Cream glaze, special order)
- countertop (Corian, Oyster, special order)

APPLIANCES

- washer (Samsung, Stratus Grey, Model WF337AAG, #255995)
- gas dryer (Samsung, Stratus Grey, Model DV337AGG, #256006)
- stacking kit (Samsung, Model SK-4A, #260236)

PLUMBING

- faucets (American Standard, wall-mounted, Model 7292.152, special order)

LIGHTING

- recessed lights (Halo, compact fluorescent, #119430)
- recessed lighting trim (Halo, Model 470SC, special order)
- flush-mounted ceiling fixtures (Good Earth Lighting, fluorescent, Neptune White, #51017)

- under-cabinet lights (Portfolio, low-voltage halogen, 2-light, #42585)

PAINT

- wall primer (Kilz Premium, latex, white, #45548)
- wall paint (Olympic Premium, Morning Breeze D62-1, eggshell)
- floor epoxy (Seal-Krete Epoxy-Seal, Blue Ridge, #16205)
- chair paint (Olympic Premium, white, satin, #33250)
- paint for tubs (Rust-Oleum, Cold Galvanizing Compound, #26719)

HOME ORGANIZATION

- closet rod mounting brackets (#179929)
- laundry sorter (chrome and canvas, #115926)

MILLWORK

- ceiling planks (Armstrong, WoodHaven Series, white, special order)

- 1 (48- x 96-inch) peg-board panel (white, #15484)

- closet rod (#3586)

SHELF PROJECT

- 1 (8-foot-long) 1 x 6¹
- 1 (8-foot-long) 1 x 10¹
- 1 (4-foot-long) 1 x 12¹
- 1 box (1 $\frac{1}{2}$ -inch) screws
- wood glue (Titebond II, #41217)
- wood filler
- primer (Kilz Premium, latex, white, #45548)

*Does not include labor costs or applicable taxes, which vary by market.

**Does not include lead time for special-order materials.

†Availability varies by market.

Lowe's Installation Available Lowe's can provide guaranteed professional installation of cabinetry, countertops, appliances, faucets, and interior lighting.

Save With ENERGY STAR® A qualified washer can lower your utility bills by as much as \$110 per year.



innovation

» At Lowe's, we bring you new products that enhance and simplify your life. Two innovative choices make this laundry room more energy-efficient.

■ The Samsung washer features new technology that uses stainless steel ball bearings to balance loads and reduce noise and vibration. The dryer (shown above) includes nine drying cycles, five temperature selections, a stainless steel drum, and a special rack for delicate clothing.

■ The ENERGY STAR® qualified compact fluorescent recessed lights from Halo (right) conserve power and lower energy bills.

